



Short Specification:

The Linear Fluorescent Highbays offer cost-effective lighting for medium and highbay applications. Their design features a precision-formed Miro reflector to achieve maximum light output. They're made out of the highest quality materials and use class P electronic ballasts. Please contact your Louvers International sales representative today for more information.



SERIES	# OF LAMPS	LAMP TYPE	VOLTAGE	BALLAST TYPE
LIHB = Linear Fluorescent Highbay	4 = 4 Lamp 6 = 6 Lamp	T5HO T8	120-277V 347-480V	T8 IS = T8 Instant Start T8 PS = T8 Program Start T5 = Program Start

Applications:

For most industrial or retail applications where low or highbay units are required such as:

- Distribution Centers
- Manufacturing Facilities
- Retail Stores
- Sports Facilities
- Warehouses

Features:

- Die-formed heavy-gauge cold rolled steel housing
- Post painted white finish
- Miro4 silver reflector
- Ballasts are accessible by removal of socket plate screws. Reflector swings out on hinged edges
- All ballasts are Class P and CEE approved

Additional Options:

- Occ. Sensor
- Battery Back-up
- Cage Guard
- Lens (Different Options Available)
- Hanging Cables

LINEAR FLUORESCENT HIGH BAY

4 AND 6 LAMP

Dimensions:

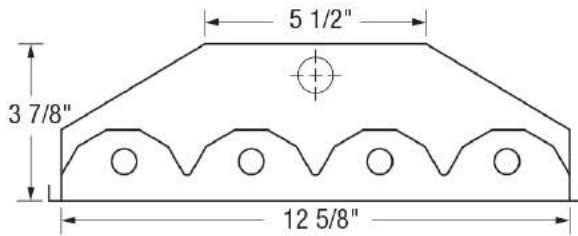

4-Lamp High Bay End View

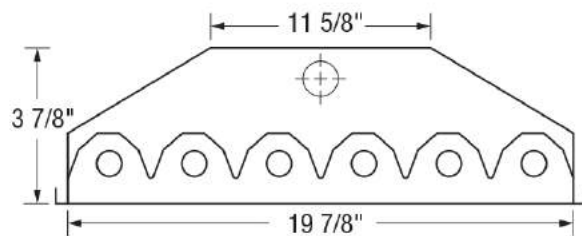

6-Lamp High Bay End View

Exploded View with Optional Wireguard and Doorframe Assembly:

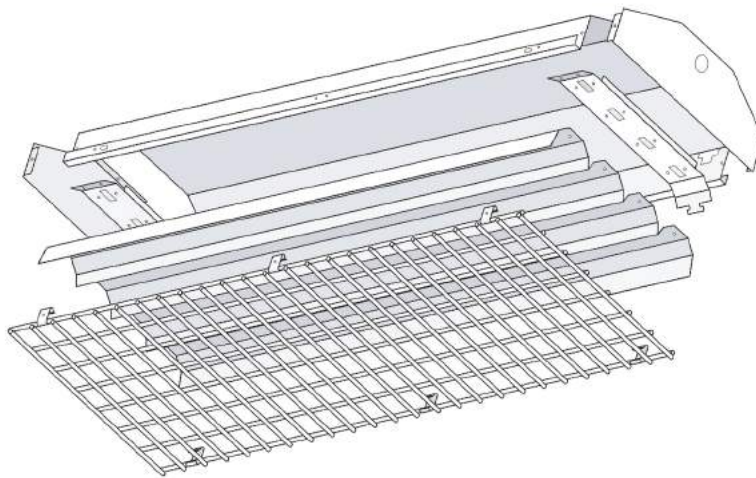

Door and Lens Kit:



LINEAR FLUORESCENT HIGH BAY 4 AND 6 LAMP

Ordering Information:

--	--	--	--

FIXTURE	BALLAST TYPE (T8 ONLY)	VOLTAGE	CORD & PLUG OPTIONS	FACTORY INSTALLED OPTIONS
LIHB4T5HO	IS = Instant Start	U = 120/277V	{leave blank} - None	{leave blank} - None
LIHB6T5HO	PS = Program Start	H = 347/480V	15B	I320(120V) = IOTA Battery Backup for 120V
LIHB4T8			15W	I320(277V) = IOTA Battery Backup for 277V
LIHB4T8LW			65B	OS = Occ Sensor (On/Off)
LIHB4T8HL			65W	CG = Cage Guard
LIHB6T8			1L5B	DLK1 = Window Clear Acrylic Door & Lens Kit
LIHB6T8LW			1L5W	DLK2 = Window Clear Polycarbonate Door & Lens Kit
LIHB6T8HL			1L6B	DLK3 = Optix95™ Door & Lens Kit
			1L6W	F32T8/850/HL
			1L7B	F32T8/841/HL
			1L7W	F54T5/850/HO
			1SB	F54T5/841/HO
			1SW	
			6FW	
			6L5B	
			6L5W	
			6L6B	
			6L6W	
			6L7B	
			6L7W	
			6SB	
			6SW	
	* T5 ballasts are only available in Program Start			* Other lens materials, lamp wattages and CCT are available. Please consult factory for more info.

Sample Part Number: LIHB4T8PS-U-6FW-OS-CG-F32T8/850/HL

Fixture Descriptions:

- HO designates high output ballast (T5 only) ≈ 1.15 ballast factor
- LW designates low watt ballast(s) ≈ 0.77 ballast factor
- HL designates high lumen ballast(s) ≈ 1.18 ballast factor
- No designation (T8 only) constitutes normal ballast factor ≈ 0.88

Lamp Descriptions:

- F32T8/850/HL – T8 Linear Fluorescent Lamp 32W/ 85CRI/ 5,000K High Lumen
- F32T8/841/HL – T8 Linear Fluorescent Lamp 32W/ 85CRI/ 4,100K High Lumen
- F54T5/850/HO – T5 Linear Fluorescent Lamp 54W/ 85CRI/ 5,000K High Output
- F54T5/841/HO – T5 Linear Fluorescent Lamp 54W/ 85CRI/ 4,100K High Output

Cord & Plug Options Descriptions:

- 15B – 10' Black 5-15 Straight Blade Plug
- 15W – 10' White 5-15 Straight Blade Plug
- 65B – 6' Black 5-15 Straight Blade Plug
- 65W – 6' White 5-15 Straight Blade Plug
- 1L5B – 10' L5-15 Black 120V Twist Lock
- 1L5W – 10' L5-15 White 120V Twist Lock
- 1L6B – 10' L6-15 Black 250V Twist Lock
- 1L6W – 10' L6-15 White 250V Twist Lock
- 1L7B – 10' L7-15 Black 277V Twist Lock
- 1L7W – 10' L7-15 White 277V Twist Lock
- 1SB – 10' Standard Black 120/277V (No Plug)
- 1SW – 10' Standard White 120/277V (No Plug)
- 6FW – 6' Flexible Whip
- 6L5B – 6' L5-15 Black 120V Twist Lock
- 6L5W – 6' L5-15 White 120V Twist Lock
- 6L6B – 6' L6-15 Black 250V Twist Lock
- 6L6W – 6' L6-15 White 250V Twist Lock
- 6L7B – 6' L7-15 Black 277V Twist Lock
- 6L7W – 6' L7-15 White 277V Twist Lock
- 6SB – 6' Standard Black 120/277V (No Plug)
- 6SW – 6' Standard White 120/277V (No Plug)

* Other cord and plug options are available, subject to special order pricing; please contact your sales representative today.