

### Short Specification:

Everyone already sells a flat panel, we're just making the process a whole lot more fun and easy with our "gravy panels". Instead of being edge lit like most flat panels, we are actually backlighting the frosted plastic lens to give the same effect as a flat panel. These fixtures are geared to the more economically conscience consumer, but we didn't fall short on performance or reliability. Jump aboard the gravy train and put our version of the flat panel in your next lighting application.

### Options:

- Surface Mount Kit for 2x2 and 2x4
- Aircraft Cable Hanging Kit - 2 point and 4 point



### Applications:

- Offices
- Schools
- Libraries
- Health Care

### Features:

- UL Listed
- 2x2, 2x4, and 1x4 sizes available
- Multiple Wattages Available for Each Size
- Frosted Plastic Lens
- 120-277v
- 50/60Hz
- Power Factor >0.9
- 3500K, 4000K, and 5000K CCT's readily available
- 80 CRI
- 0-10v dimming (down to 10%)
- Integrated Linear Driver
- -20 °C to 40 °C Operating Temperature Range
- 5 year warranty



#### 2x4

30 Watts - 3900 Lumens  
40 Watts - 5200 Lumens  
50 Watts - 6500 Lumens



#### 2x2

20 Watts - 2600 Lumens  
25 Watts - 3250 Lumens  
30 Watts - 3900 Lumens  
36 Watts - 4680 Lumens



#### 1x4

25 Watts - 3250 Lumens  
30 Watts - 3900 Lumens  
40 Watts - 5200 Lumens



ULTRA BRIGHT



ANTI-GLARE



FLICKER-FREE



ENERGY SAVING



ROBUST DESIGN

### DIMENSIONS

2x4

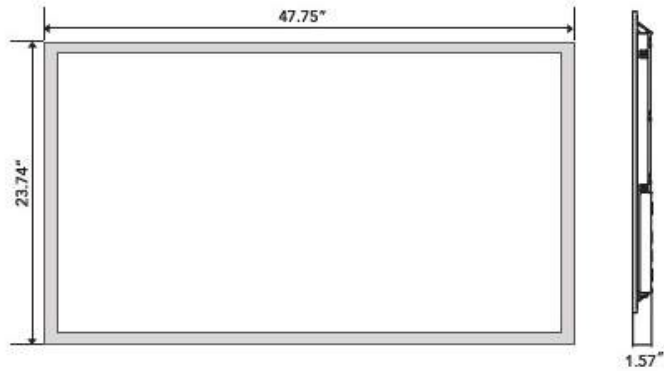

2x2

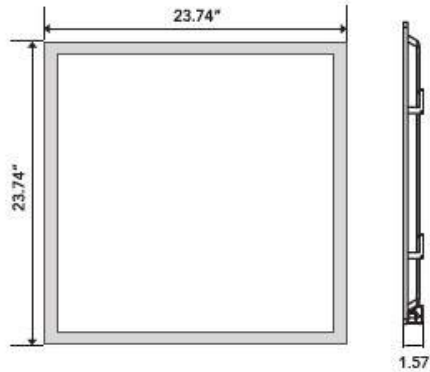
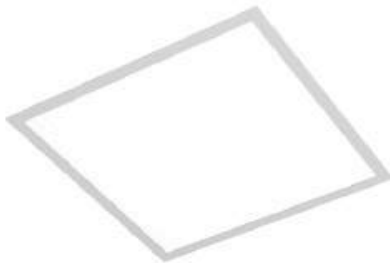

1x4

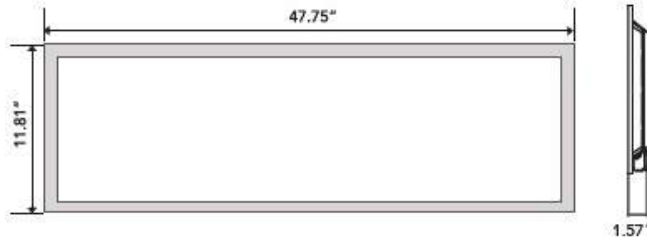



### MOUNTING ACCESSORIES

#### Gravy Panel Surface Mount Kit

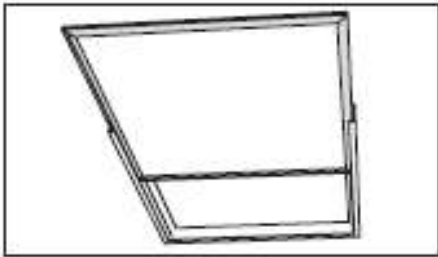

GP-SMK-22-W  
GP-SMK-24-W

#### Gravy Panel Cable Mount Kit

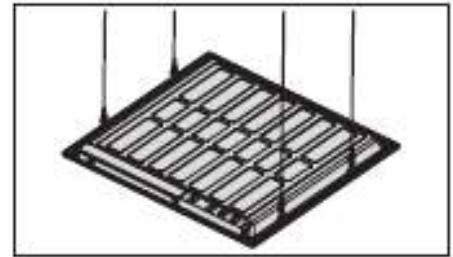

GP-CMK-2  
GP-CMK-4

### SURFACE MOUNT INSTRUCTIONS

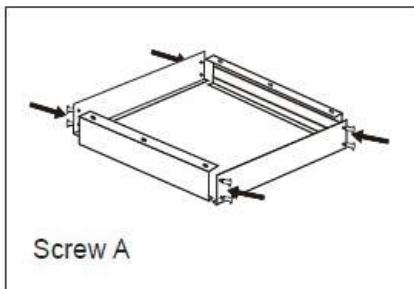

Screw A

1. Assemble the four sides with 2 X screw A each to create the frame.

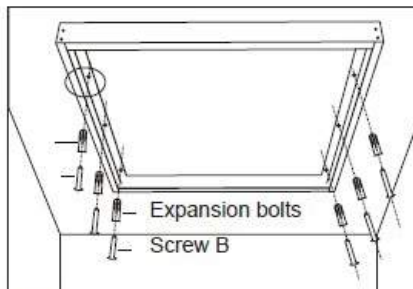

Expansion bolts  
Screw B

2. Fix the frame to the ceiling with screw B and expansion bolts.

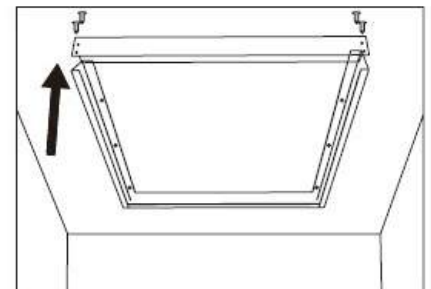

3. Once securely mounted to the ceiling disassemble one end (without mounting screws to the ceiling).

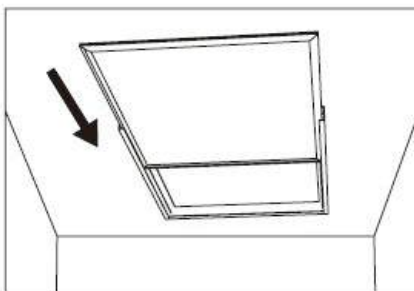

4. Insert the panel into the frame square.

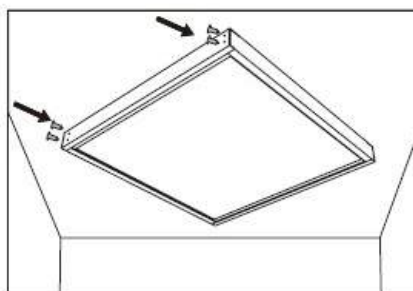

5. Reassemble the remaining end with screw A.



### CABLE MOUNT INSTRUCTIONS

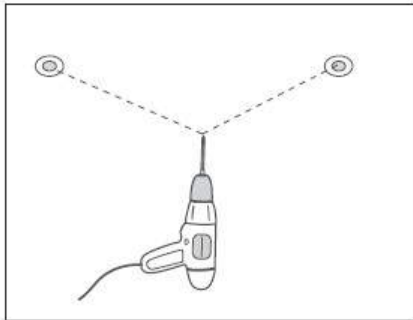

1. According to the length and the width of the panel light, drill four mounting holes on the mounting position.

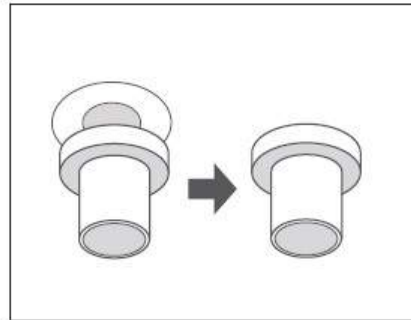

2. Fix the upper cover to mounting hole.

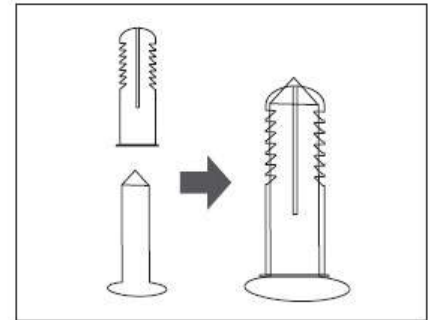

3. Fix the screw inside the expansion bolt to get the self-tapping screw.

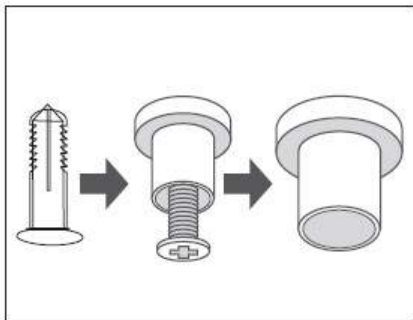

4. Use self-tapping screw to lock the upper cover to mounting hole.

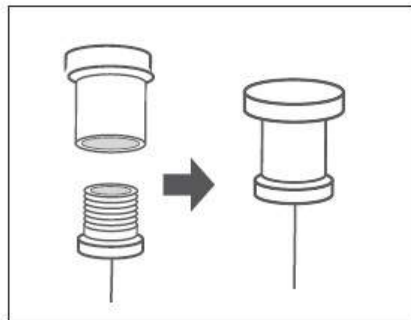

5. Twist matching the lower cover to the upper cover. Complete the connection of cable and bearing load.

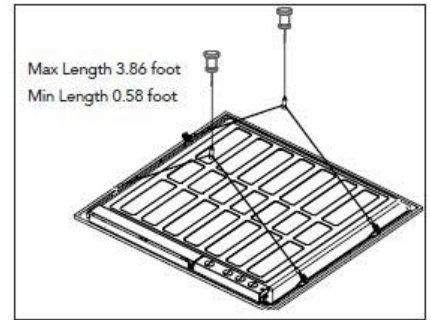

6. Release wire and connect to panel light. Buckle up the suspension hooks to the triangle hooks attached on panel light.

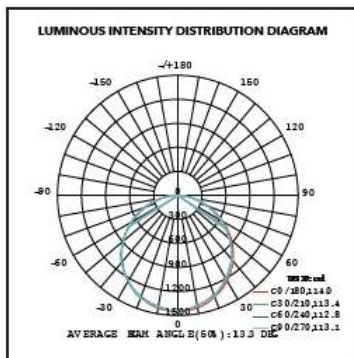

LAMBERTIAN

### Part Numbers / Ordering Chart

Model	Size	Wattage	Input Voltage	CCT	CRI	Dimming	Category
GP	24 = 2x4	40W 50W	U = 120-277v	35K = 3500K 40K = 4000K 50K = 5000K	80	D = 0-10v Dimming	P = Premium
	22 = 2x2	20W 25W 30W 36W					
	14 = 1x4	25W 30W 40W					

SEE CHART BELOW FOR  
STOCK MODELS

SAMPLE PART NUMBER: GP-24-40-U-35K-80-D-P

Please check DLC QPL for all current listings.

### STOCK MODELS

MODEL #	SIZE	WATTS	LUMENS	CCT
GP-24-40-U-35K-80-D-P		40	5000	35K
GP-24-40-U-40K-80-D-P		40	5100	4K
GP-24-50-U-35K-80-D-P	2x4	50	6250	35K
GP-24-50-U-40K-80-D-P		50	6375	4K
GP-24-50-U-50K-80-D-P		50	6375	5K
GP-22-30-U-35K-80-D-P		30	3750	35K
GP-22-30-U-40K-80-D-P		30	3825	4K
GP-22-36-U-35K-80-D-P	2x2	36	4500	35K
GP-22-36-U-40K-80-D-P		36	4590	4K
GP-22-36-U-50K-80-D-P		36	4590	5K
GP-14-30-U-35K-80-D-P		30	3750	35K
GP-14-30-U-40K-80-D-P	1x4	30	3825	4K

Please check DLC QPL for all current listings.

**ALL OTHER OPTIONS ARE 12+ WEEK LEAD TIME**

